

March 17-1885

Survey for John E. Slater - on Section 23 S 6 N. R. 2 W. Beginning at the S. W. cor. Sec 23, and chaining North 40.00 chains - also continuing North 12.85 and then triangulated as follows:

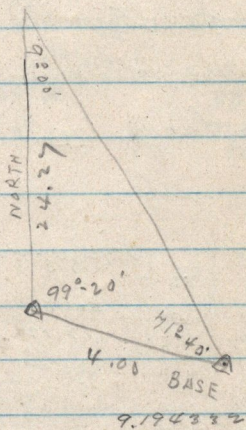

9.194332

$\log \sin 9^\circ = 0.805668$

$\log \sin 71^\circ 40' = 9.977377$

$\log 4.00 = 0.602060$

$\log 24.27 = 1.385105$
385070

Resulting in a point $\left. \begin{matrix} 179 \\ 2.88 \text{ ch} \end{matrix} \right\} \begin{matrix} 55.0 \\ 2 \end{matrix}$ South from the North West corner of Section 23 - at which corner the following observations were made

